

# rolly<sup>®</sup> trac lader

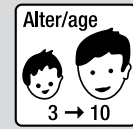

rolly toys Kundendienst Deutschland:

Tel: +49 (0) 95 68 / 856-142  
Fax: +49 (0) 95 68 / 856-183  
e-mail: service@rollytoys.de

2016/11

934.000.800.00

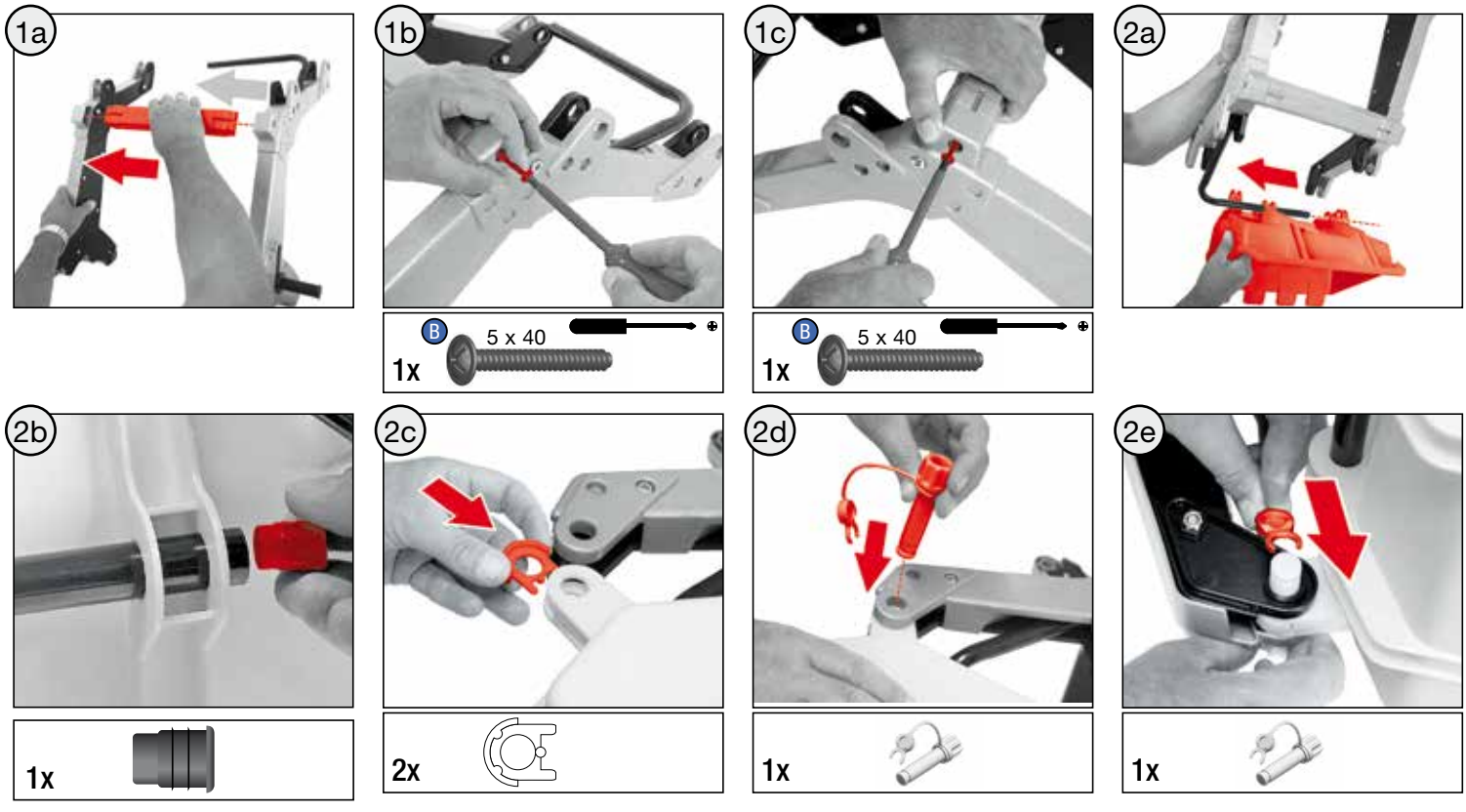

## ⚠ WARNING

- CHOKING HAZARD - Small parts, Danger of being swallowed. Contains small parts in non assembled state. Must be assembled by adults.
- Toy is not suitable to carry children.
- If toy is defective stop using it, repairs may only be carried out by adults.
- Adult supervision required.
- Never use near steps, slopes, driveways, hills, roadways, alleys or swimming pool areas.
- Always wear shoes.
- Conforms to the requirements of ASTM Standard Consumer Safety Specification on Toy Safety, F 963.

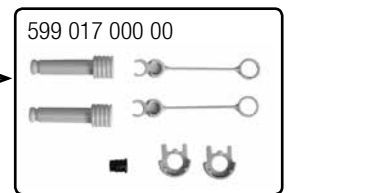
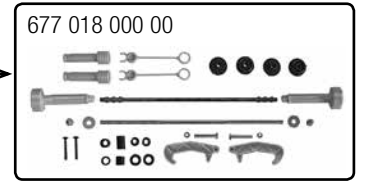
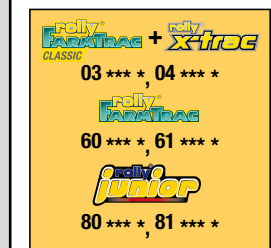
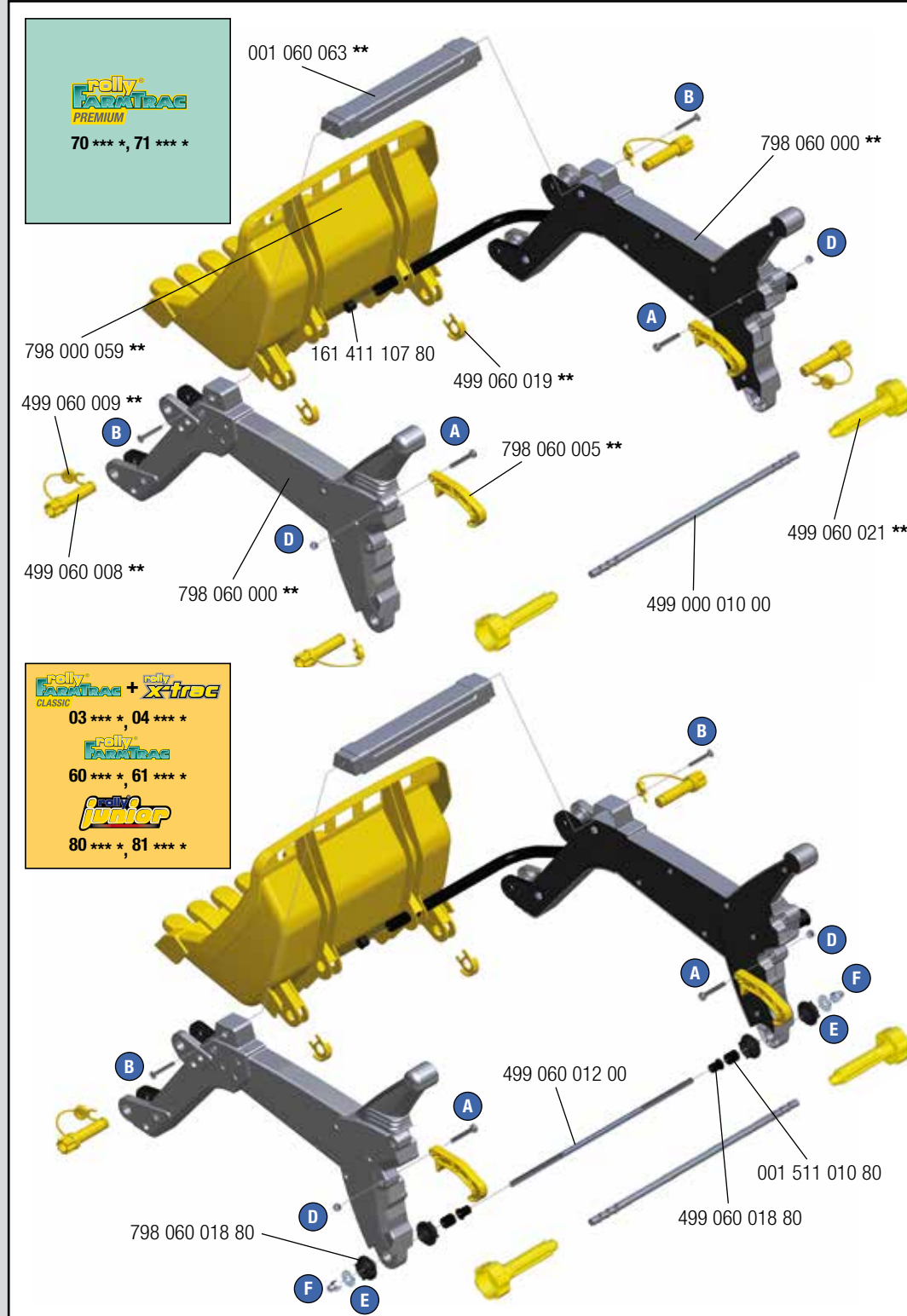

→ \*\*

● +10	● +26	● +47
● +12	● +30	● +51
● +13	● +37	● +54
● +20	● +40	● +70
● +22	● +41	● +75
● +23	● +44	● +80

--- NORTH & SOUTH AMERICA only ---  
**180 days warranty**

From the date of purchase + guaranteed spare part service  
The warranty does not cover damages caused by improper use or neglect



made in Germany



rolly toys  
Franz Schneider GmbH & Co KG  
P.O.Box 1460  
D-96459 - Neustadt bei Coburg · Germany  
Tel.: +49 (0) 95 68 / 856-0  
Fax.: +49 (0) 95 68 / 856-190  
www.rollytoys.com



**reilly FARATRAC PREMIUM**  
70 \*\*\* , 71 \*\*\*  
(A - I)

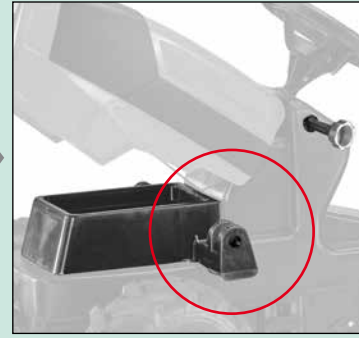
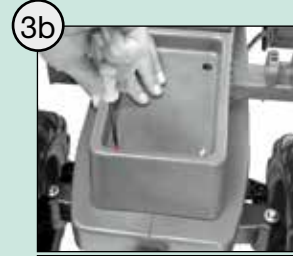
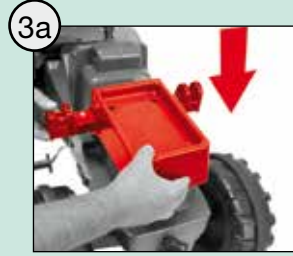

**B** 5 x 40  
2x **C** 3 x 20

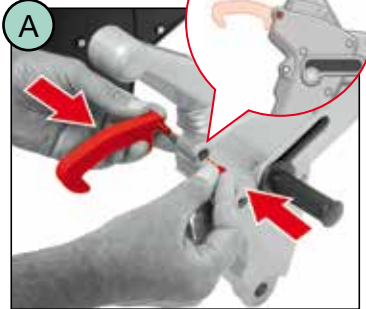

**A** M6 x 40  
1x **D** M6

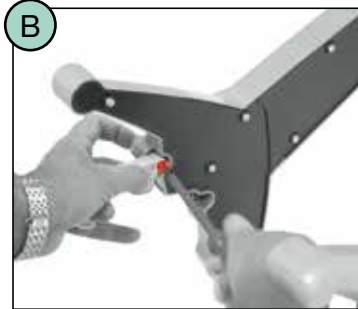

1x

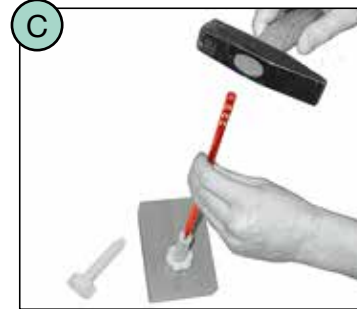

**C**  $\varnothing 8 \times 335\text{mm}$   
1x

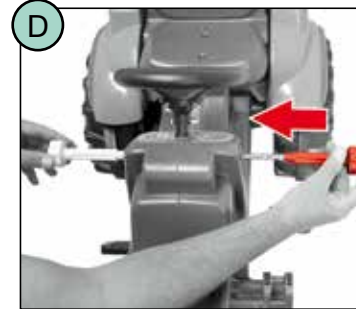

1x

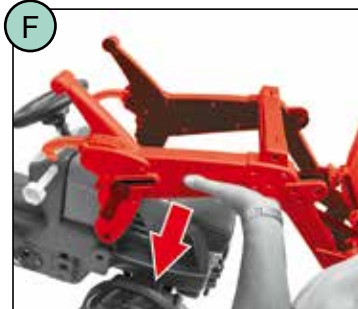
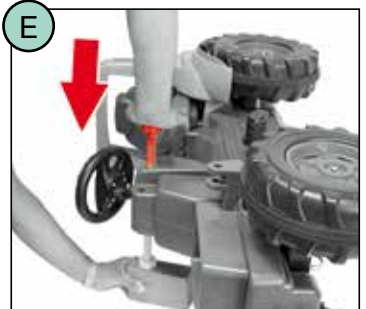

2x

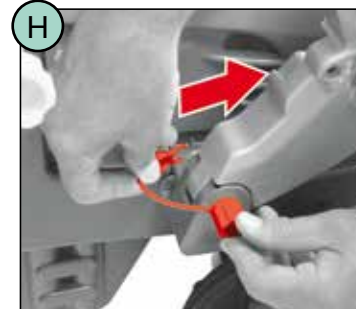

**A** M6 x 40  
2x 798 506 040 00

**D** M6  
2x 098 506 000 00

**E**  $\varnothing 8,4 \times \varnothing 24$   
2x 902 184 000 00

**F** M8  
2x 098 608 000 00

**B** AMTEC 5 x 40  
2x 520 060 540 00

**C**  $\varnothing 3 \times 20$   
2x 750 503 020 00

0 10 20 30 40 50 mm (metrisch • metric)

**reilly FARATRAC + reilly XTAC CLASSIC**  
03 \*\*\* , 04 \*\*\*  
**reilly FARATRAC**  
60 \*\*\* , 61 \*\*\*  
**reilly junior**  
80 \*\*\* , 81 \*\*\*  
(J - Z)

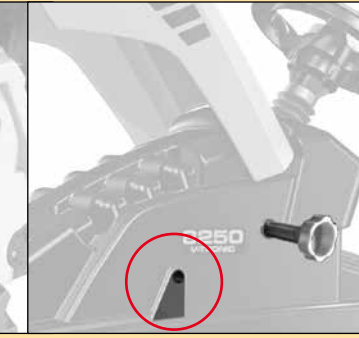
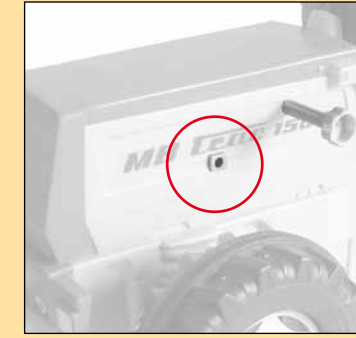

**A** M6 x 40  
1x **D** M6

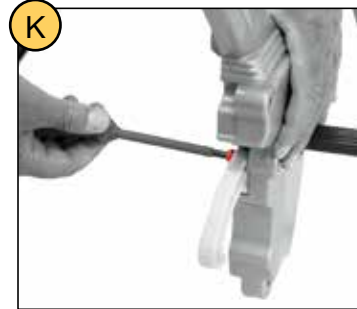

1x



**L**  $\varnothing 8 \times 335\text{mm}$   
1x

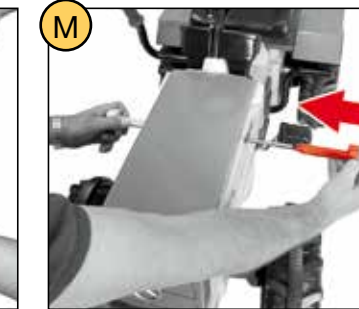

1x

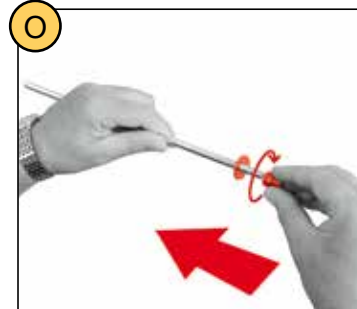
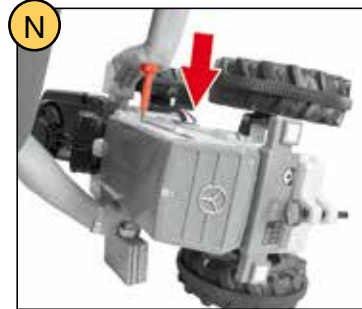

**O**  $\varnothing 8 \times 345\text{mm}$   
1x



**P** 2x  $\varnothing 12 \times 16\text{mm}$

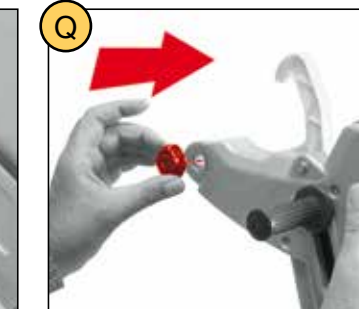

1x



1x

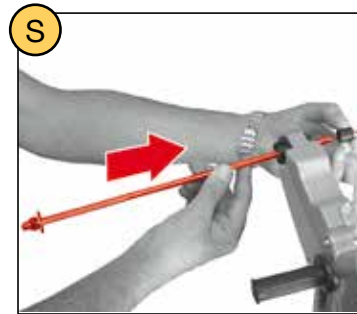

1x

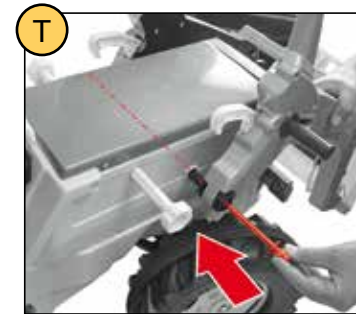

1x

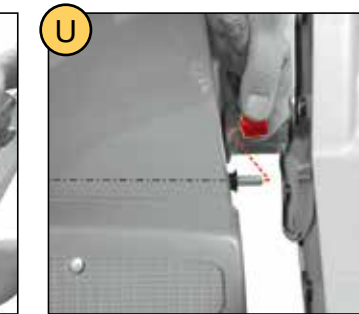

1x

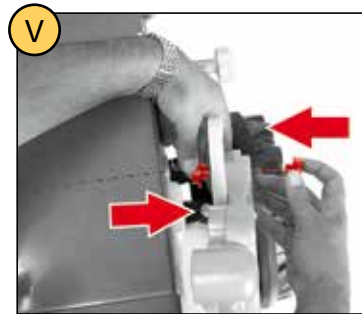

1x

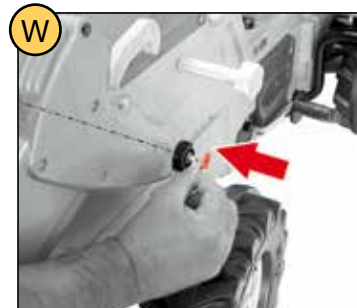

**W**  $\varnothing 8,4 \times \varnothing 24$   
1x

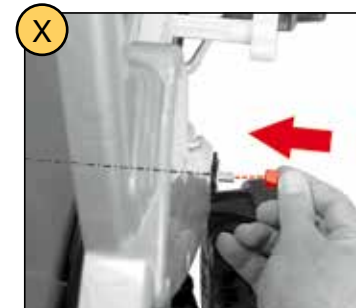

**X** M8  
1x

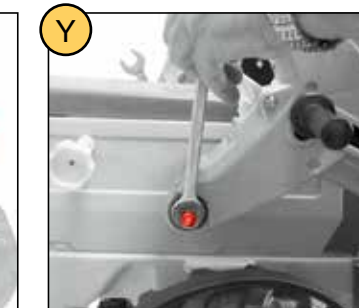

**Y** 13  
1x

